



OVERVIEW

The ValveWorks USA Model VW-FC consists of a lineup of gate valves with reliable, proven designs that are engineered and manufactured to meet the requirements of 6A. This model of gate valves offers the user several options depending on the specific application including achieving a positive seal at wellbore/flowline pressures ranging from 3,000 to 5,000

PSI. Model VW-FC gate valves are full-bore valves. This allows for downhole tools to be passed through the wellhead and reduces turbulent flow. Model VW-FC valves are similar to each other in design with only slight variations across the lineup, offering a high percentage of parts interchangeability, giving you an efficiency-driven advantage in the management and maintenance of your gate valve fleet and providing optimal lifecycle management integrity.

This brochure provides an in-depth look at the details of this series of gate valves and explains the features, benefits, characteristics, dimensional & technical data and other valuable information needed to determine which valve suits your specific application.

TABLE 1 - PRODUCT FEATURES

	MODEL VW-FC
FLOW DIRECTION	BIDIRECTIONAL
AVAILABLE BORE SIZES^a & RATED WORKING PRESSURES (psi)	2 1/16" 5/10/15K 2 9/16" 5/10/15K 3 1/8" 3/5K 3 1/16" 10/15K 4 1/16" 3/5/10K
AVAILABLE PSL^b	1,2,3,3G
MATERIAL CLASSES	AA,BB,EE,FF, HH
VALVE BODY	FORGED
GATE TYPE	SLAB
SEALING ACTION	PRESSURE ENERGIZED
OPERATION TYPE	MANUAL ^c
BORE TYPE	THROUGH-CONDUIT ^d
GATE / SEAT SEAL	METAL TO METAL
STEM TYPE	NON-RISING
STEM PACKING TYPE	OPTI-SEAL
REPACKING	YES ^e
THRUST BEARINGS	2 ^f
BODY LUBRICATION FITTINGS	1
BODY / BONNET CONNECTION	BOLTED
END CONNECTIONS	FLANGED (RTJ)
TEMPERATURE RANGE	-75°F (-60°C) THRU 250°F (121°C)

a) 2 1/16" x 1 13/16", 3 1/8" x 3 3/16", 4 1/16" x 4 1/8", and 4 1/16" x 4 1/4" available upon request.

b) Product Specification Level

c) Also referred to as "HANDWHEEL OPERATED"

d) Also referred to as "FULL-OPENING".

e) Repacking is achieved via backseat method.

f) Valve bonnet equipped with grease ports and fittings for bearing lubrication.

TABLE 2 - TEMPERATURE RATINGS

TEMPERATURE CLASSIFICATION	OPERATING RANGE
K	-75°F (-60°C) TO 180°F (82°C)
L	-50°F (-46°C) TO 180°F (82°C)
N	-50°F (-46°C) TO 140°F (60°C)
P	-20°F (-29°C) TO 180°F (82°C)
S	0°F (-18°C) TO 140°F (60°C)
T	0°F (-18°C) TO 180°F (82°C)
U	0°F (-18°C) TO 250°F (121°C)
V	35°F (2°C) TO 250°F (121°C)

TABLE 3 - MATERIAL REQUIREMENTS

MATERIAL CLASS		MINIMUM MATERIAL REQUIREMENTS	
		BODY, BONNET END & OUTLET CONNECTIONS	PRESSURE-CONTROLLING PARTS & STEMS
AA	GENERAL SERVICE	CARBON OR LOW-ALLOY STEEL	CARBON OR LOW-ALLOY STEEL
BB	GENERAL SERVICE	CARBON OR LOW-ALLOY STEEL	STAINLESS STEEL
CC	GENERAL SERVICE	STAINLESS STEEL	STAINLESS STEEL
DD	SOUR SERVICE ^a	CARBON OR LOW-ALLOY STEEL ^b	CARBON OR LOW-ALLOY STEEL ^b
EE	SOUR SERVICE ^a	CARBON OR LOW-ALLOY STEEL ^b	STAINLESS STEEL ^b
FF	SOUR SERVICE ^a	STAINLESS STEEL ^b	STAINLESS STEEL ^b
HH	SOUR SERVICE ^a	CRA ^{acd}	CRA ^{acd}

a) As defined by ISO 15156 (all parts) (NACE MR0175; See Clause 2).

b) In accordance with ISO 15156 (NACE MR0175; See Clause 2).

c) CRA required on retained-fluid wetted surfaces only.

d) CRA as defined in Clause 3; ISO 15156 (all parts) (NACE MR0175; See Clause 2) definition of CRA does not apply.

MODEL VW-FC GATE VALVE

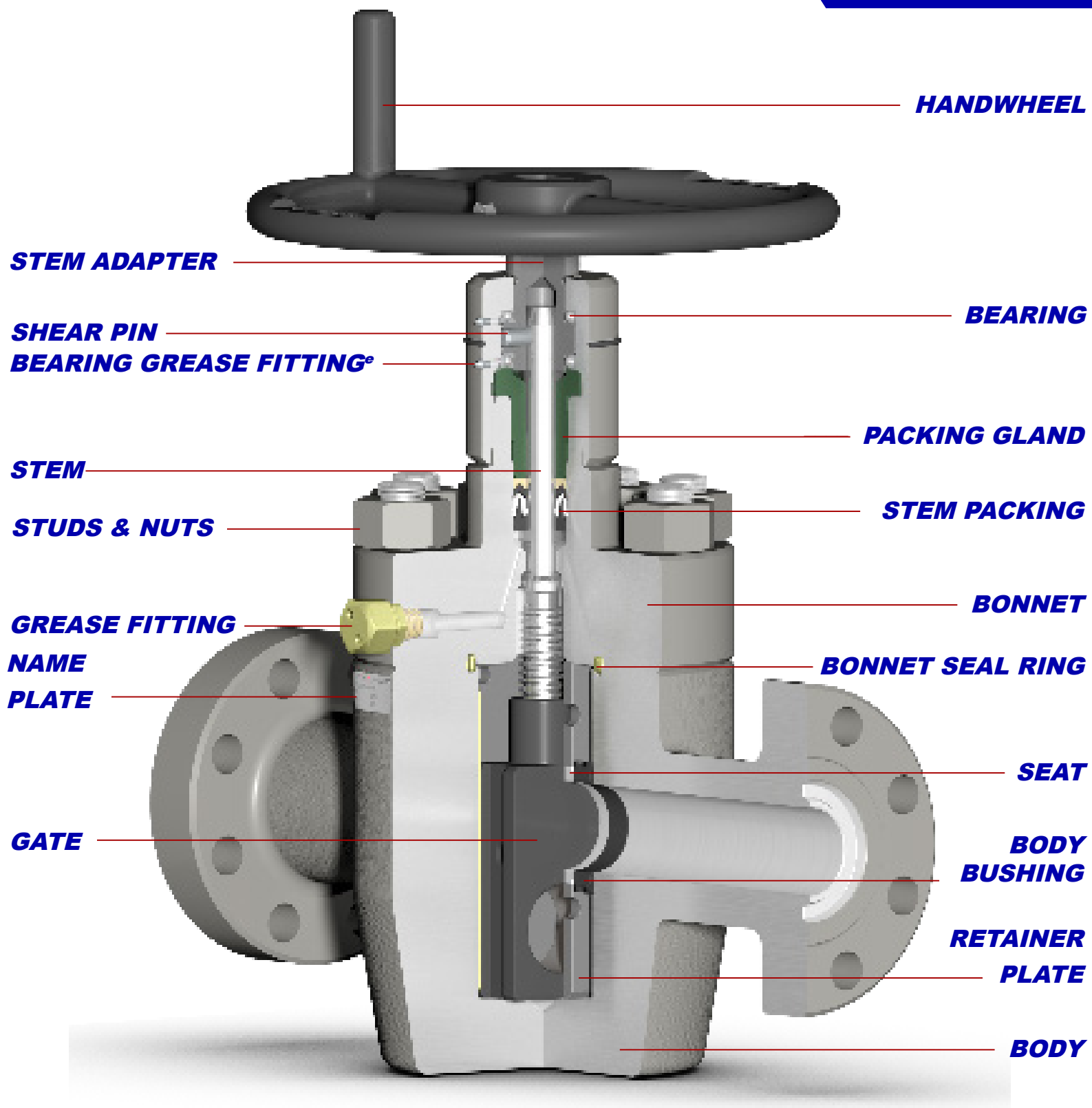

*THE ACTUAL PRODUCT MAY VARY SLIGHTLY FROM SHOWN SCHEMATIC DUE TO ENGINEERING APPROVED VARIATION

ENGINEERED - DESIGNED - VERIFIED - QUALITY ASSURED - CERTIFIED - FIELD PROVEN - CREDIBLE - SUPPORTED

MODEL VW-FC GATE VALVE

DIMENSION TABLE KEY

- A** FACE TO FACE
- B** VALVE BORE SIZE
- C** BORE CENTERLINE TO BOTTOM
- D** BORE CENTERLINE TO TOP
- E** HANDWHEEL DIAMETER
- NT** NUMBER OF TURNS
- RJ** RING JOINT
- BSS** BONNET STUD SIZE
- N** NUMBER OF STUDS
- WT** APPROXIMATE WEIGHT
- HT** HANDWHEEL OPERATING TORQUE

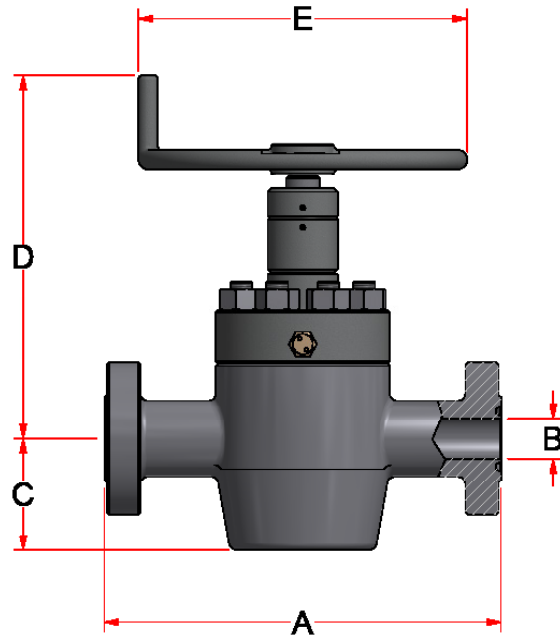

SIZE	WP (PSI)	A	B	C	D	E	NT	RJ	BSS	N	WT (LBS)	HT (FT-LBS)
1 13/16	10K	18 1/4	1 13/16	5 13/16	18 13/16	16	11 3/4	BX-151	1-1/8	8	270	59
	15K	18	1 13/16	6 13/16	18 13/16	16	11 3/4	BX-151	1-1/8	8	275	89
2 1/16	5K	4 5/8	2 1/16	5 7/8	18 7/8	14	12	R-24	7/8	8	189	32
	10K	20 1/2	2 1/16	5 13/16	18 13/16	16	12 1/2	BX-152	1-1/8	8	275	66
	15K	19	2 1/16	6 1/8	18 13/16	16	12 1/2	BX-152	1-1/4	8	350	103
2 9/16	5K	16 5/8	2 9/16	6 5/16	19 1/2	16	16 1/4	R-27	1	8	275	49
	10K	22 1/4	2 9/16	6 7/8	19 5/8	20	16	BX-153	1-1/4	8	485	111
	15K	21	2 9/16	7 13/16	22 7/8	20	15 1/2	BX-153	1-1/8	12	520	221
3 1/8	3K	17 1/8	3 1/8	7 13/16	20 1/2	16	17 1/2	R-31	1 1/8	8	337	40
	5K	18 5/8	3 1/8	7 9/16	20 1/2	16	17 1/2	R-35	1 1/8	8	355	67
3 1/16	10K	24 3/8	3 1/16	8 1/8	22	23	17 1/2	BX-154	1-3/8	8	550	140
	15K	23 9/16	3 1/16	9 1/8	25 5/8	23	15 1/2	BX-154	1-3/8	12	914	308
4 1/16	3K	20 1/8	4 1/16	9 5/16	22	20	23 1/4	R-37	1 1/4	8	498	70
	5K	21 5/8	4 1/16	9 13/16	22	20	23 1/4	R-39	1 1/4	8	550	113
	10K	26 3/8	4 1/16	10 1/8	28 3/4	24	23 1/4	BX-155	1-5/8	8	950	258

VALVEWORKS USA DESCRIPTION KEY

GV , 6A , VW-FC , 2 1/16" 5M , FE , EE - KU - 1 - 2 , HWO

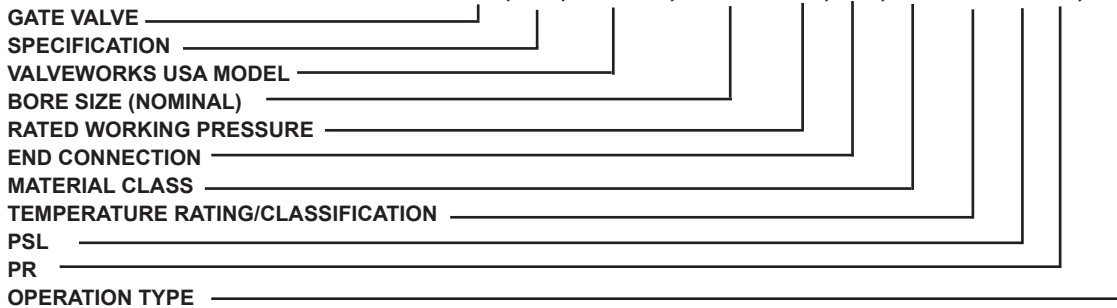

ABBREVIATION KEY

FC = MODEL VW-FC
HWO = HANDWHEEL OPERATED (MANUAL)
SG = SLAB GATE
FE = FLANGED END

RTJ = RING TYPE JOINT
PSL = PRODUCT SPECIFICATION LEVEL
PR = PERFORMANCE REQUIREMENT
CRA = CORROSION-RESISTANT ALLOY
XYL = XYLAN®
NIT = NITRIDE

*ALL DIMENSIONS ARE IN INCHES